

TNC 750



Low Profile Comp Cell

Series TNC 750

Capacities 500kg to 20,000 kg

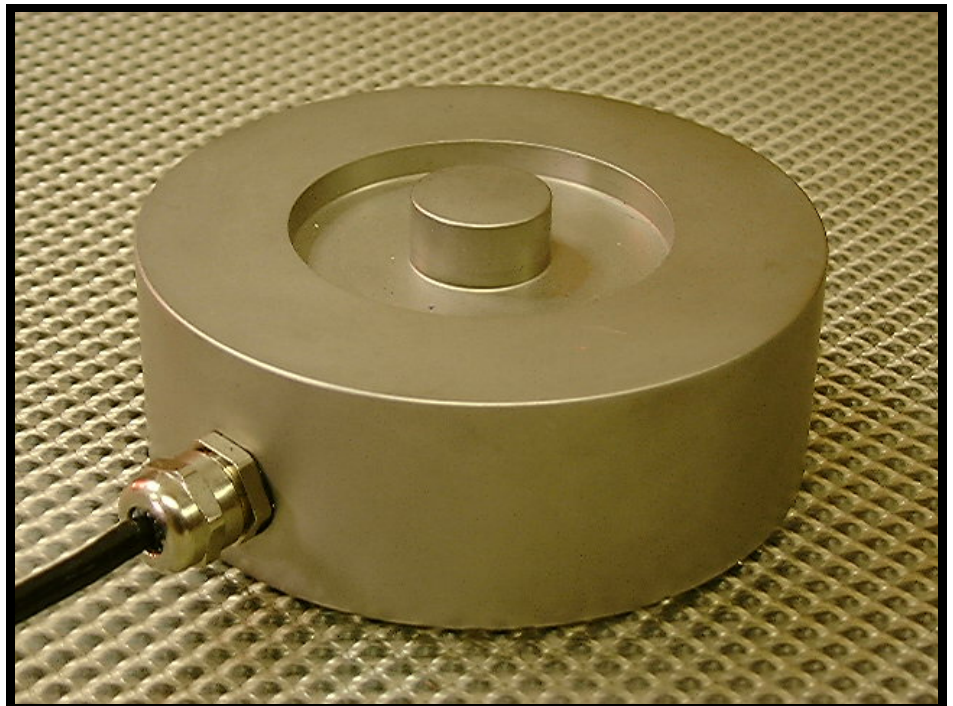

- ▶ **Stainless**
- ▶ **Integrated Load Button**
- ▶ **Rationalised Output**
- ▶ **Compression Load Cell**
- ▶ **High Accuracy**
- ▶ **Sealed to IP68**



STRAIN MEASUREMENT TECHNOLOGY

Creating a pathway to your solution

TNC 750

Technical Data

Standard load ranges	te	0.5, 1, 1, 2, 5, 10, 20
Full load output	mV/V	2.0 (+/-0.25%)
Excitation voltage (recommended) dc or ac	V	10
Excitation voltage (maximum) dc or ac	V	15
Safe service load	%	150
Ultimate load	%	300
Combined error (non linearity and hysteresis)	%	+/- 0.2
Repeatability	%	+/- < 0.1
Output at zero load	%	< +/- 2.0
Input resistance	Ω	750 +/- 20
Output resistance	Ω	700 +/- 5
Operational temperature range	$^{\circ}\text{C}$	- 20 to +70
Compensated temperature range	$^{\circ}\text{C}$	- 10 to + 50
Temperature coefficient of zero	%/ $^{\circ}\text{C}$	+/- 0.005
Temperature coefficient of span	%/ $^{\circ}\text{C}$	+/- 0.005
Environmental protection		IP 68
Insulation	G Ω	>2 at 100V dc
Construction		stainless steel

Note: All percentages related to Full Rated Load

Electrical Connections

Red + Input **Yellow - Output**
Blue + Input **Green + Output**
Screen O/C

All Dimensions in mm

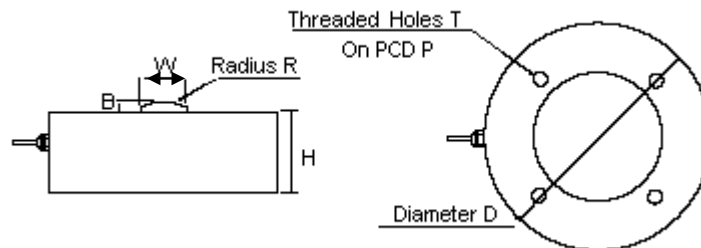

Capacity	H	B	W	R	D	T	P
0.5, 1	21	4	10	50	59	M3x7	42
2,5,10,20	35	5	20	150	98	M6x18	72

TNC's policy is one of continuous development and these specifications are subject to change without notice



Creating a pathway to your solution

Unit C3 Acre Business Park, Acre Road, Berkshire RG2 0SA.
 Telephone: 0118 9314107 Facsimile: 01189 9314971
www.tncelectronics.co.uk email: sales@tncelectronics.co.uk